

Key to Loudspeaker Types	
MAIN HALL	B.B
(A) Stalls Main Left Right	(A) Flown Left Centre Right
(B) Front Fills - Stage Edge	(B) Subwoofers
(C) Front Fills - Pit Lift 1	(C) Front Fills
(D) Front Fills - Pit Lift 2	(D) Side Speakers
(E) Side Surrounds	(E) Surrounds - 1
(F) Stalls Delays	(F) Surrounds - 2
(G) Rear Surrounds	(G) Surrounds - 3
(H) Stalls Mid Rear Surrounds	(H) Rear Delays
(I) Balcony Main Left Right	(I) Stage Support
(J) Balcony 1 Delays	(J) Overhead
(K) Balcony 2 Delays	
(L) Flown Subwoofer Array	
(M) Stalls Subwoofers	
(N) Flown Main Left Right Array	
(O) Centre Array	
- - 스피커와 스피커사이 공배관 (ST 22C)	
- - 스피커와 TRAY DUCT사이 공배관 (ST 22C)	

SC MH LOUDSPEAKER LAYOUT - 1F
 SCALE : 1/100 (A1)
 SCALE : 1/200 (A3)

SOUND AND COMMUNICATIONS
 MH LOUDSPEAKER LAYOUT - 1F

SC-LAY-102



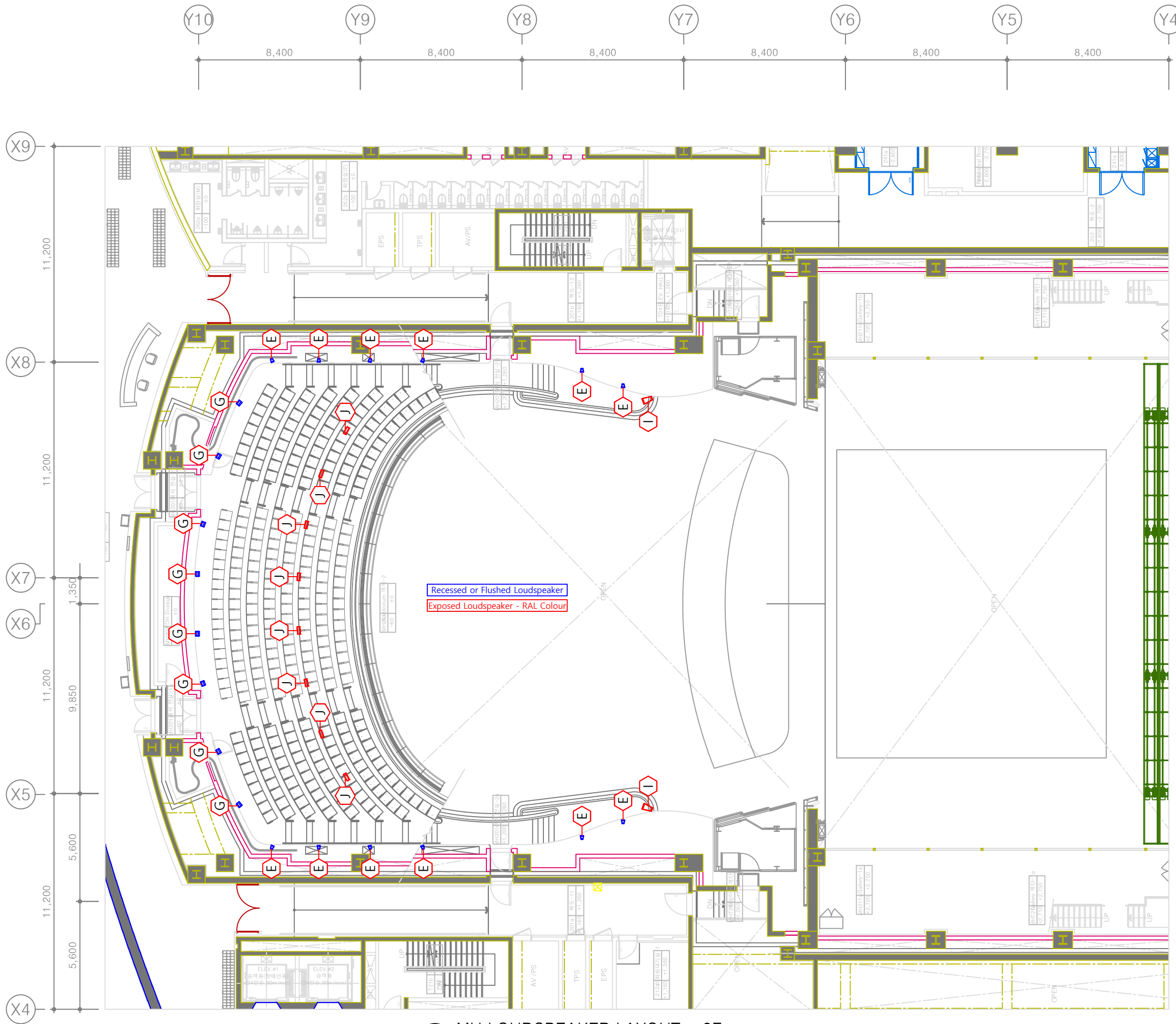

Key to Loudspeaker Types	
MAIN HALL	B.B
⊙ Stalls Main Left Right	⊙ Flown Left Centre Right
⊙ Front Fills - Stage Edge	⊙ Subwoofers
⊙ Front Fills - Pit Lift 1	⊙ Front Fills
⊙ Front Fills - Pit Lift 2	⊙ Side Speakers
⊙ Side Surrounds	⊙ Surrounds - 1
⊙ Stalls Delays	⊙ Surrounds - 2
⊙ Rear Surrounds	⊙ Surrounds - 3
⊙ Stalls Mid Rear Surrounds	⊙ Rear Delays
⊙ Balcony Main Left Right	⊙ Stage Support
⊙ Balcony 1 Delays	⊙ Overhead
⊙ Balcony 2 Delays	
⊙ Flown Subwoofer Array	
⊙ Stalls Subwoofers	
⊙ Flown Main Left Right Array	
⊙ Centre Array	
--- 스피커와 스피커사의 공배관 (ST 22C) --- 스피커와 TRAY DUCT사의 공배관 (ST 22C)	

SOUND AND COMMUNICATIONS
MH LOUDSPEAKER LAYOUT - 2F

SC-LAY-103



SC MH LOUDSPEAKER LAYOUT - 2F
SCALE : 1/100 (A1)
SCALE : 1/200 (A3)

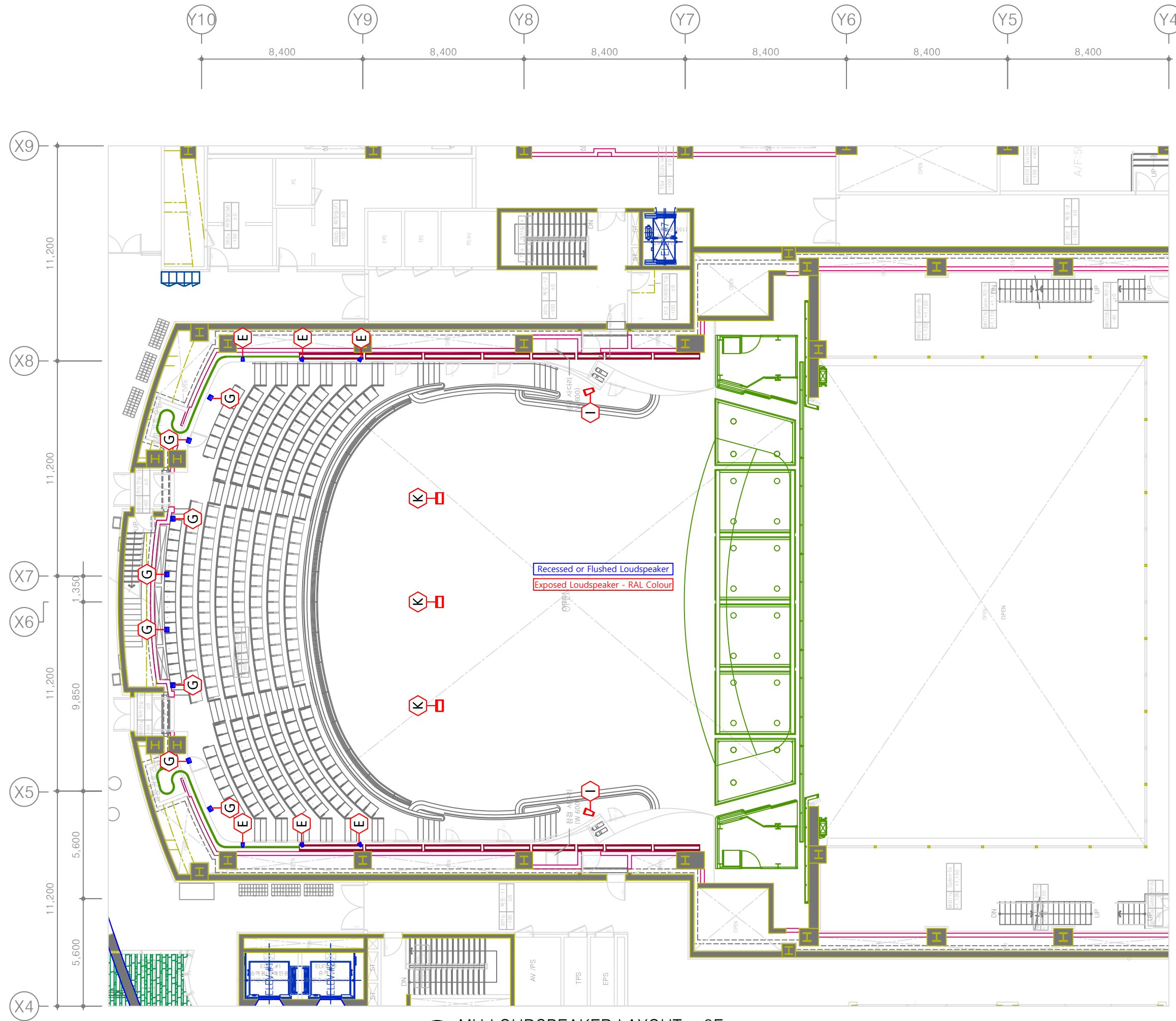

Key to Loudspeaker Types	
MAIN HALL	B.B
⊙ A Stalls Main Left Right	⊙ A Flown Left Centre Right
⊙ B Front Fills - Stage Edge	⊙ B Subwoofers
⊙ C Front Fills - Pit Lift 1	⊙ C Front Fills
⊙ D Front Fills - Pit Lift 2	⊙ D Side Speakers
⊙ E Side Surrounds	⊙ E Surrounds - 1
⊙ F Stalls Delays	⊙ F Surrounds - 2
⊙ G Rear Surrounds	⊙ G Surrounds - 3
⊙ H Stalls Mid Rear Surrounds	⊙ H Rear Delays
⊙ I Balcony Main Left Right	⊙ I Stage Support
⊙ J Balcony 1 Delays	⊙ J Overhead
⊙ K Balcony 2 Delays	
⊙ L Flown Subwoofer Array	
⊙ M Stalls Subwoofers	
⊙ N Flown Main Left Right Array	
⊙ O Centre Array	
- - - 스피커와 스피커사이 공백관 (ST 22C)	
- - - 스피커와 TRAY DUCT사이 공백관 (ST 22C)	

SC MH LOUDSPEAKER LAYOUT - 3F
 SCALE : 1/100 (A1)
 SCALE : 1/200 (A3)

SOUND AND COMMUNICATIONS
 MH LOUDSPEAKER LAYOUT - 3F

SC-LAY-104



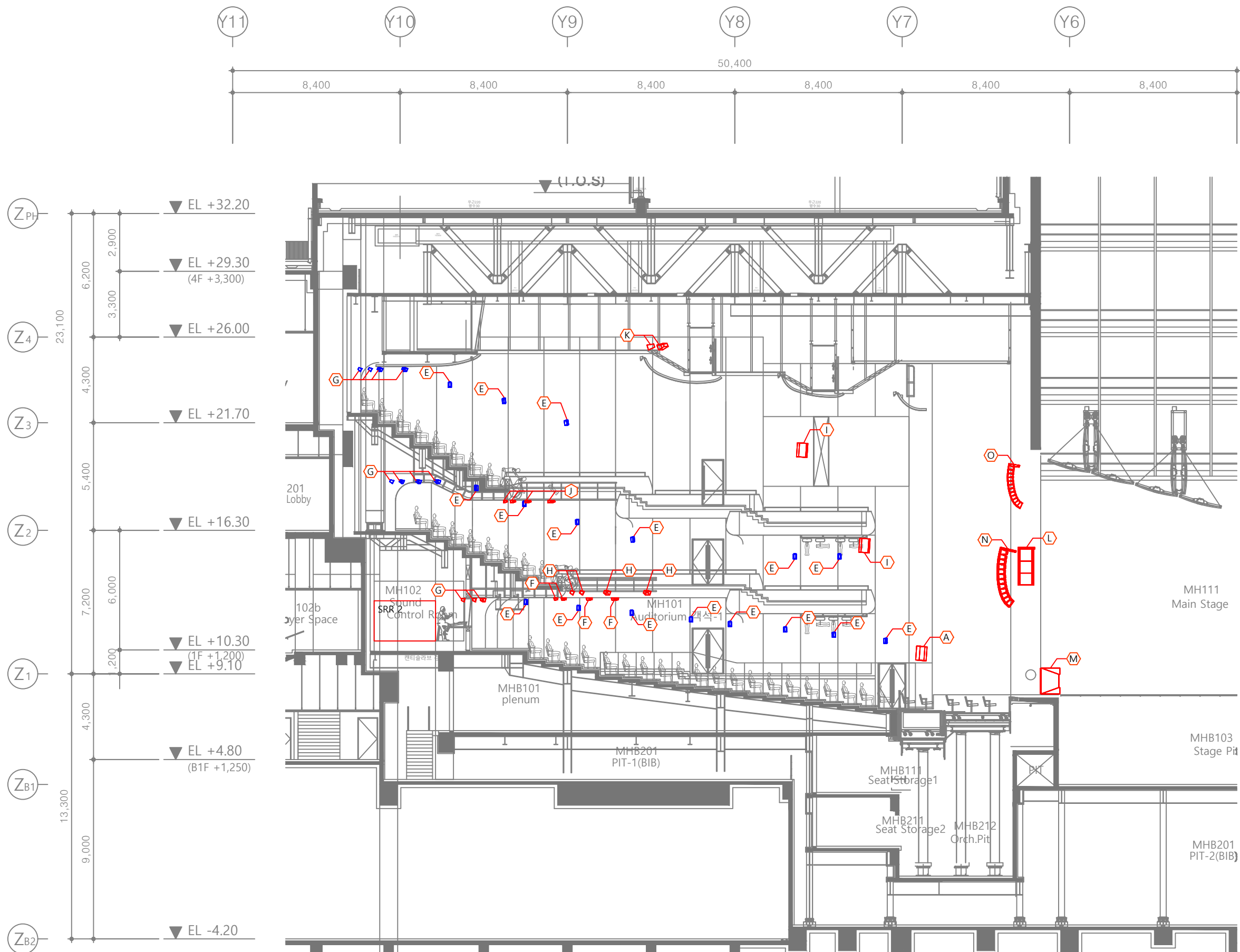

Key to Loudspeaker Types	
MAIN HALL	B.B
⊙ Stalls Main Left Right	⊙ Flown Left Centre Right
⊙ Front Fills - Stage Edge	⊙ Subwoofers
⊙ Front Fills - Pit Lift 1	⊙ Front Fills
⊙ Front Fills - Pit Lift 2	⊙ Side Speakers
⊙ Side Surrounds	⊙ Surrounds - 1
⊙ Stalls Delays	⊙ Surrounds - 2
⊙ Rear Surrounds	⊙ Surrounds - 3
⊙ Stalls Mid Rear Surrounds	⊙ Rear Delays
⊙ Balcony Main Left Right	⊙ Stage Support
⊙ Balcony 1 Delays	⊙ Overhead
⊙ Balcony 2 Delays	
⊙ Flown Subwoofer Array	
⊙ Stalls Subwoofers	
⊙ Flown Main Left Right Array	
⊙ Centre Array	
--- 스피커와 스피커사이 공배관 (ST 22C) --- 스피커와 TRAY DUCT사이 공배관 (ST 22C)	

SOUND AND COMMUNICATIONS
MH LOUDSPEAKER LAYOUT SECTION

SC-LAY-105



SC MH LOUDSPEAKER LAYOUT SECTION
SCALE : 1/100 (A1)
SCALE : 1/200 (A3)